

# BOCA RANCHO SOUTH

## PALM BEACH COUNTY, FLA.

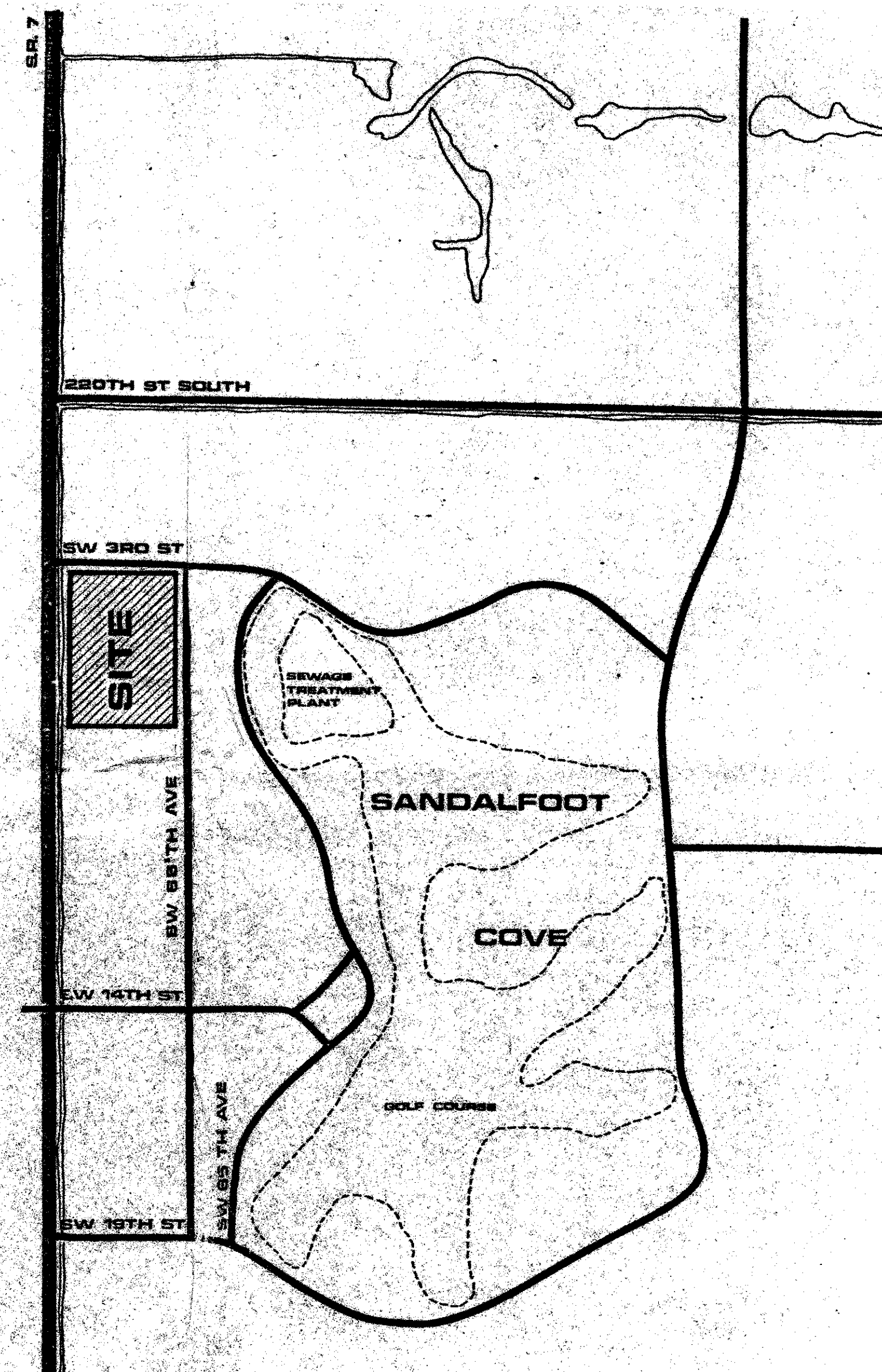

**LOCATION**  
1" = 800'

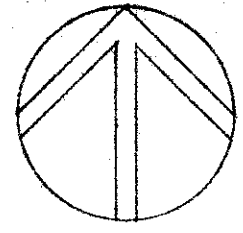

### PROJECT DATA

PARCEL ZONING	RH
TOTAL AREA	24.71 ACRES
STREETS R/W	2.00 ACRES
NET AREA	22.71 ACRES
MAXIMUM NUMBER OF UNITS ALLOWED	282
APTS. UNITS PROPOSED (TOTAL)	280
1 BDR.	24
2 BDR.	208
3 BDR.	48
PARKING FACILITIES (TOTAL)	577
HANDICAPPED SPACES	12
DENSITY (GROSS)	11.33 U/ACRE
" (NET)	12.33 U/ACRE
RECREATIONAL FACILITIES (LAND)	5.32 ACRES*
LAKE	3.87 ACRES

\* Plus equivalent dollar value of the facilities to be developed (minimum amount of land required based on a population of 728, 280 units x 2.6 is 3.64 acres.)

**DEVELOPER:** BOCA RANCHO DEVELOPMENT CORP.  
22250 Boca Rancho Drive  
Boca Raton, Florida 33433  
Phone: 832-8833

**ENGINEER:** ROSSI & MALAVASI ENGINEERS, INC.  
1675 Palm Beach Lakes Blvd.  
West Palm Beach, Fla. 33401  
Phone: 689-0555 - 689-0554

**PLANNER** MENENDEZ & ASSOCIATES  
ARCHITECTS, PLANNERS, INC.  
1675 Palm Beach Lakes Blvd.  
Forum III, Suite 407  
West Palm Beach, Fla. 33401  
Phone: 689-0714

ur0258.igr  
BOCA RANCHO SOUTH PROJECT DATA

RECEIVED  
MAR -5 1980  
LAND DEVELOPMENT  
PALM BEACH COUNTY